

# SOUTHLAND

PRONAUBEC



Style that sets you apart

Made in CANADA



2686 D

2 Unsurpassed pontoon boat

Champagne SX & Champagne Edition 3



Champagne SX. Also see it page 20

Sundeck



Teak floor & table

Top-of-the-line fiberglass helm console



Mahogany sink cover & stainless steel hand rail (Optional)



(Removable front module available)  
(Optional front oval table & front glass door)



Champagne SX 2686 D

(Optional front oval table)



Champagne 2686 D



CHAMPAGNE SX & CHAMPAGNE EDITION (3 TOONS)

	2686	2486
<b>Measurements: length x width</b>	<b>26' x 8'-6" / 7,9 m x 2,59 m</b>	<b>24' x 8'-6" / 7,31 m x 2,59 m</b>
<b>Approximate weight</b>	2 700 lb / 1 227 kg	2 500 lb / 1 136 kg
<b>Tubes: (2 or 3) Diameter</b>	<b>(3) - 25" / 635 mm</b>	<b>(3) - 25" / 635 mm</b>
<b>Maximum capacity: weight - passengers</b>	3 615 lb / 1 643 kg - 16	3 360 lb / 1 527 kg - 16
<b>Maximum H.P. capacity</b>	270 H.P. / 201 kW	230 H.P. / 172 kW

CHAMPAGNE SX & CHAMPAGNE EDITION (2 TOONS)

	2686	2486
<b>Measurements: length x width</b>	<b>26' x 8'-6" / 7,9 m x 2,59 m</b>	<b>24' x 8'-6" / 7,31 m x 2,59 m</b>
<b>Approximate weight</b>	2 400 lb / 1 091 kg	2 225 lb / 1 011 kg
<b>Tubes: (2 or 3) Diameter</b>	<b>(2) - 25" / 635 mm</b>	<b>(2) - 25" / 635 mm</b>
<b>Maximum capacity: weight - passengers</b>	3 210 lb / 1 459 kg - 16	2 860 lb / 1 300 kg - 15
<b>Maximum H.P. capacity</b>	150 H.P. / 112 kW	150 H.P. / 112 kW

See photo montage on pages 18 & 19 showing various features and options. Some features shown may not be available on all models. You can find the complete list of standard and optional equipment on pages 22 & 23.



2486 D

6

l m p e c c a b l e f i n i s h

\*On standard model the vinyl is non pleated.  
See picture p.8

X-Stream RA 7

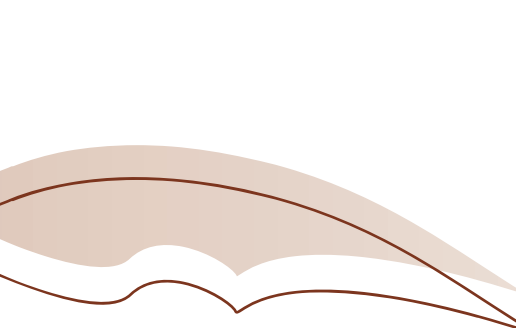

(Optional removable front seat )



X-Stream RA 2486 D



2486 D

Interior ambient LED floor lighting with 10 LED lights at floor level (Optional)



Anodized fixed & folding ladder with platform (Optional on the X-Stream model)



Sun umbrella (Optional)



Storage net on the chaise lounge



X-Stream RA fiberglass console (with built-in cooler), sink, glove compartment and door



X-Stream RA console with fiberglass dash panel

X-STREAM RA (3 TOONS)

	2486	2286
<b>Measurements: length x width</b>	<b>24' x 8'-6" / 7,31 m x 2,59 m</b>	<b>22' x 8'-6" / 6,7 m x 2,59 m</b>
Approximate weight	2 550 lb / 1 159 kg	2 400 lb / 1 091 kg
Tubes: <b>(2 or 3)</b> Diameter	<b>(3)</b> – 25" / 635 mm	<b>(3)</b> – 25" / 635 mm
Maximum capacity: weight - passengers	3 390 lb / 1 541 kg – 16	2 665 lb / 1 211 kg – 14
Maximum H.P. capacity	230 H.P. / 172 kW	175 H.P. / 130 kW

X-STREAM RA (2 TOONS)

	2486	2286
<b>Measurements: length x width</b>	<b>24' x 8'-6" / 7,31 m x 2,59 m</b>	<b>22' x 8'-6" / 6,7 m x 2,59 m</b>
Approximate weight	2 275 lb / 1 034 kg	2 150 lb / 977 kg
Tubes: <b>(2)</b> – 25" / 635 mm	<b>(2)</b> – 25" / 635 mm	<b>(2)</b> – 25" / 635 mm
Maximum capacity: weight - passengers	2 895 lb / 1 316 kg – 15	2 545 lb / 1 157 kg – 13
Maximum H.P. capacity	150 H.P. / 112 kW	115 H.P. / 86 kW

See photo montage on pages 18 & 19 showing various features and options. Some features shown may not be available on all models. You can find the complete list of standard and optional equipment on pages 22 & 23.

- 1. Couch/Removable bed
- 2. Half cones/Deck



1



2

Shore lights with remote control (Optional)



Luxuria RA & Luxuria console with fiberglass dash panel



Multi-function module (Optional)



Luxuria RA 2486 C

(Optional removable front seat )



Diamond 2080 D



	DIAMOND (2 TOONS)	
	1880	2080
<b>Measurements: length x width</b>	<b>18' x 8'-6" / 5,48 m x 2,59 m</b>	<b>20' x 8'-6" / 6,09 m x 2,59 m</b>
Approximate weight	1 300 lb / 591 kg	1 500 lb / 682 kg
Tubes: <b>(2 or 3)</b> Diameter	<b>(2) – 25" / 635 mm</b>	<b>(2) – 25" / 635 mm</b>
Maximum capacity: weight - passengers	1786 lb / 812 kg – 8	2 015 lb / 916 kg – 10
Maximum H.P. capacity	75 H.P. / 56 kW	90 H.P. / 67 kW

	LUXURIA RA (24'-22") / LUXURIA (22") (3 TOONS)		LUXURIA RA (24'-22") / LUXURIA (22'-20'-18") (2 TOONS)			
	2486	2286	2486	2286	2086	1886
<b>Measurements: length x width</b>	<b>24' x 8'-6" / 7,31 m x 2,59 m</b>	<b>22' x 8'-6" / 6,7 m x 2,59 m</b>	<b>24' x 8'-6" / 7,31 m x 2,59 m</b>	<b>22' x 8'-6" / 6,7 m x 2,59 m</b>	<b>20' x 8'-6" / 6,09 m x 2,59 m</b>	<b>18' x 8'-6" / 5,48 m x 2,59 m</b>
Approximate weight	2 550 lb / 1 159 kg	2 350 lb / 1 068 kg	2 275 lb / 1 034 kg	2 100 lb / 955 kg	1 850 lb / 841 kg	1 500 lb / 682 kg
Tubes: <b>(2 or 3)</b> Diameter	<b>(3) – 25" / 635 mm</b>	<b>(3) – 25" / 635 mm</b>	<b>(2) – 25" / 635 mm</b>	<b>(2) – 25" / 635 mm</b>	<b>(2) – 25" / 635 mm</b>	<b>(2) – 24" / 610 mm</b>
Maximum capacity: weight - passengers	2 974 lb / 1 352 kg – 14	2 679 lb / 1 218 kg – 12	2 460 lb / 1 118 kg – 14	2 251 lb / 1 023 kg – 11	2 356 lb / 1 071 kg – 11	1 800 lb / 812 kg – 9
Maximum H.P. capacity	200 H.P. / 149 kW	175 H.P. / 130 kW	150 H.P. / 112 kW	115 H.P. / 86 kW	95 H.P. / 71 kW	75 H.P. / 56 kW

See photo montage on pages 18 & 19 showing various features and options. Some features shown may not be available on all models. You can find the complete list of standard and optional equipment on pages 22 & 23.

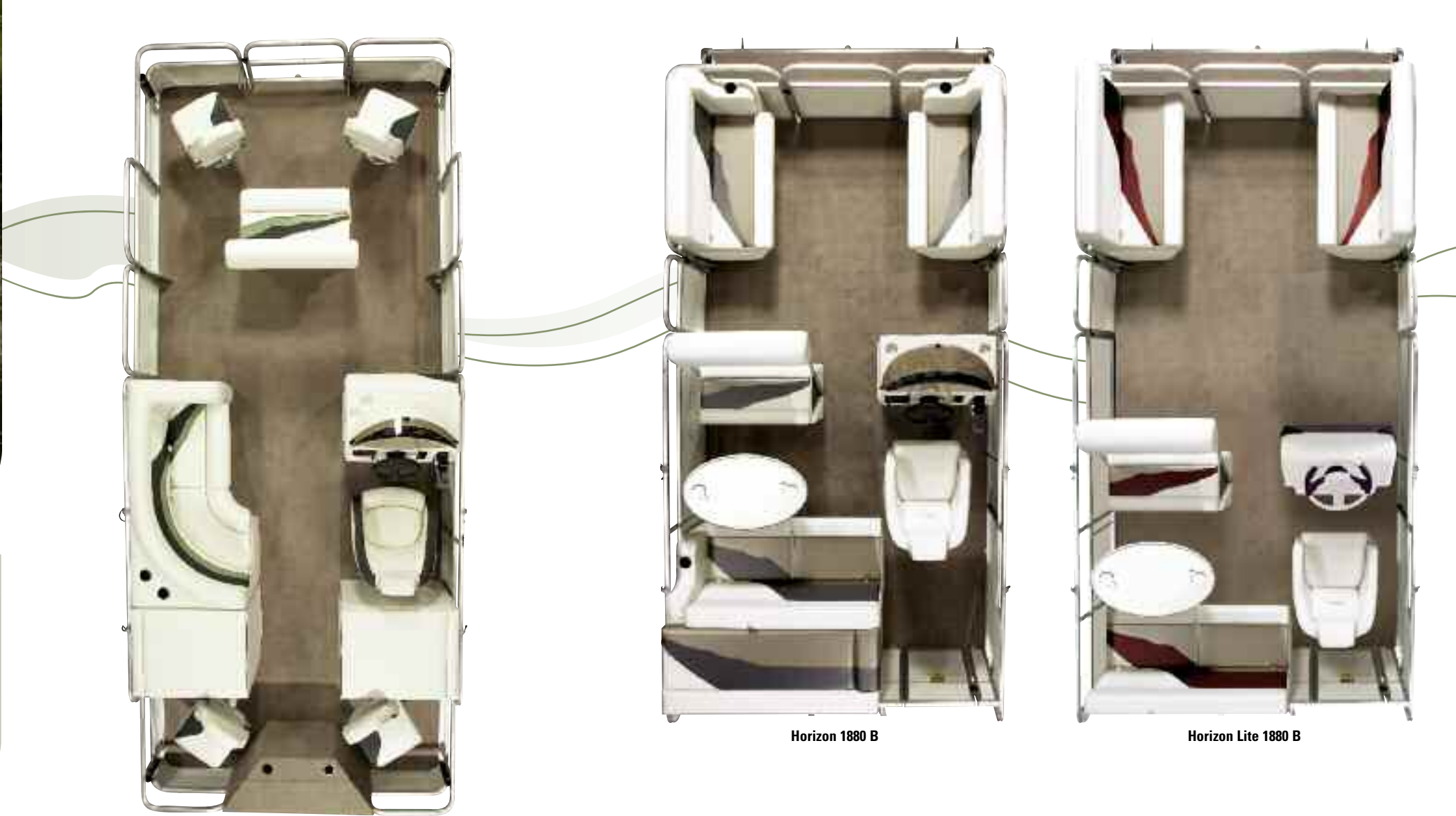

Dressing room



Portable sun umbrella on fishing seat (Optional)



BBQ (Optional)

Fishing DLX 2080 F

Horizon 1880 B

Horizon Lite 1880 B



Horizon console with dash panel



Underseat storage tray (Optional)



Fly SE 1880

	FISHING DLX (3 TOONS)		FISHING DLX (2 TOONS)	
	2486	2486	2080	
<b>Measurements: length x width</b>	<b>24' x 8'-6" / 7,31 m x 2,59 m</b>	<b>24' x 8'-6" / 7,31 m x 2,59 m</b>	<b>20' x 8'-0" / 6,09 m x 2,44 m</b>	
Approximate weight	2 500 lb / 1 066 kg	2 175 lb / 989 kg	1 600 lb / 727 kg	
Tubes: (2 or 3) Diameter	(3) - 25" / 635 mm	(2) - 25" / 635 mm	(2) - 25" / 635 mm	
Maximum capacity: weight - passengers	3 360 lb / 1 524 kg - 15	2 544 lb / 1 156 kg - 13	2 043 lb / 929 kg - 8	
Maximum H.P. capacity	230 H.P. / 172 kW	125 H.P. / 93 kW	90 H.P. / 67 kW	

See photo montage on pages 18 & 19 showing various features and options. Some features shown may not be available on all models. You can find the complete list of standard and optional equipment on pages 22 & 23.

	HORIZON & HORIZON LITE (2 TOONS)		FLY SE & FLY (2 TOONS)			
	2080	1880	2080	1880	1680	1660
<b>Measurements: length x width</b>	<b>20' x 8'-0" / 6,09 m x 2,44 m</b>	<b>18' x 8'-0" / 5,48 m x 2,44 m</b>	<b>20' x 8'-0" / 6,09 m x 2,44 m</b>	<b>18' x 8'-0" / 5,48 m x 2,44 m</b>	<b>16' x 8'-0" / 4,88 m x 2,44 m</b>	<b>16' x 6'-0" / 4,88 m x 1,83 m</b>
Approximate weight	1 450 lb / 659 kg	1 250 lb / 568 kg	1 300 lb / 591 kg	1 100 lb / 500 kg	1 000 lb / 455 kg	900 lb / 409 kg
Tubes: (2 or 3) Diameter	(2) - 24" / 610 mm	(2) - 24" / 610 mm	(2) - 24" / 610 mm	(2) - 21" / 533 mm	(2) - 21" / 533 mm	(2) - 21" / 533 mm
Maximum capacity: weight - passengers	2 035 lb / 925 kg - 10	1 825 lb / 830 kg - 8	2 094 lb / 952 kg - 10	1 285 lb / 584 kg - 6	1 100 lb / 600 kg - 6	1 155 lb / 525 kg - 6
Maximum H.P. capacity	90 H.P. / 67 kW	75 H.P. / 56 kW	90 H.P. / 67 kW	60 H.P. / 45 kW	25 H.P. / 19 kW	25 H.P. / 19 kW



**TOPS**  
Our tops are made of « Top Gun » canvas and carry a 5-year warranty against excessive fading. Our full camper tops cover the entire deck, including the foredeck, thus preventing water infiltration under the door.

**ROTOCAST BASES**  
Furniture bases are made of roto-cast plastic.

**SEAT COVERING**  
By improving furniture covering to be softer and cozier, we have reached a new level of comfort.

**GATES**  
The gates are anodised and mounted on 1 1/4" (33 mm) tubes. The snaps, to fasten the top, are pre-installed on the gates. An adhesive strip between the gate and the fasteners reduces unpleasant noises caused by vibration. On our luxury models, some sections of the gates are lined with a foam product, thus considerably increasing rigidity. Finger savers come standard on all models.



**ABYC WIRING**  
Terminals and connectors are waterproof. We meet ABYC (American Boat and Yacht Council) standards, the highest in the marine industry.



**RADIOS/CD/MP3**  
SOUTHLAND installs only the best: marine grade CLARION. (MP3 available on deluxe models only)

**FIBERGLASS MODULES**  
The addition of two fiberglass modules in the front, gives the pontoons a racing boat look. Without forgetting their remarkable capacity of storage.

**NAVIGATION LIGHTS AND CORNERS**  
On upscale models, corners are made of moulded aluminium, coated with baked-on paint. The cleats are built-in.

**LADDER**  
The rear ladder folds and is both stylish and comfortable. Made of anodised aluminium, its steps are slip-proof.

**FIBERGLASS HELM**  
You are in total command with the Champagne model's fiberglass helm. At no additional cost, enjoy ergonomics and esthetics at their best. So much control in such little space is truly fantastic!

**SINK**  
The acrylic sink comes with a high-quality stainless steel drain and integrated stopper.

**SINK COVER**  
Made of baked laminate.

**FAUCET**  
Comes with an electric pump.

**GLOVE COMPARTMENT**  
The acrylic glove compartment is surely the biggest on the market.

**DOOR**  
Made of acrylic and designed to match the glove compartment. Its long-lasting and impeccable finish is also maintenance friendly.

**COOLER**  
Comes standard on the Champagne and X-Stream RA models. It has storage capacity of 2.4 cubic feet, a laminate door and a stainless steel handle.

**TINTED WINDSHIELD**  
Secured with quick release fasteners.

**SILVER GAUGES**  
Red lighting.

**CONTROL KNOBS**  
Lit, easy to find and have attractive retro styling.

**STAINLESS STEEL EYEBOLT**  
This U-shaped eyebolt is fastened to four Z-shaped crossmembers, under the deck.

**NOSE CONES**  
On Champagne and X-Stream RA models, nose cones have splash guards that improve looks and sturdiness.

**TOPS**  
The tops are attached to the railing thanks to quick release fasteners. Furthermore, rear stern lighting is built into the top's tubing. On the deluxe models the bimini top is 7 feet high (2.1 m), thus offering more than enough clearance for taller passengers. Very much appreciated is the depth of the rear bimini, that covers 9 feet (2.6 m) of floor space.

**STORAGE**  
Sundeck storage on our Champagne model is fantastic. Never has a pontoon offered this much. As for our X-Stream RA model, you are in for a surprise with the chaise lounges. You will appreciate their remarkable storage capacity.

**SUNDECK**  
The sundeck on the Champagne is so wide. You can make it into a very comfortable extra-large bed; and that, without having to handle or add cushions. 66" by 69" (1.6 x 1.7 m).

**DRESSING ROOM**  
The dressing room, which is 22" (552 mm) wide by 29" (711 mm) deep, offers plenty of room.

**ELECTRIC MOTOR**  
All our pontoon boats could be equipped with an electric motor.

**MOTOR MOUNT**  
We build the sturdiest motor mount on the market. In order to support more powerful engines, its all-aluminium body is bolted to 4 (or 5) Z-shaped crossmembers. Extensive testing has convinced SOUTHLAND that extending the motor mount beyond the tubes is better. Customers have confirmed that this method ensures perfect stability.

**DECK**  
The deck is made of 3/4" (19 mm) douglas, 7-ply, pressure treated (.40 CCA), marine grade plywood. The deck has a lifetime warranty against rotting, and, since it is screwed to the crossmembers every 8" (203 mm), SOUTHLAND extends this warranty to also cover warping.

**CARPET**  
Marine grade carpet quality is 28 oz (840 g) on Champagne, X-Stream RA, Luxuria RA and Luxuria models. On other models, it is 20 oz (600 g).

**TUBES**  
Since we at SOUTHLAND take your safety seriously, our tubes consist of 4 to 6 separate airtight chambers, each measuring maximum 5 feet (1.524 m). Each chamber is sealed with a rigid wall. SOUTHLAND tubes are 25" (635mm) in diameter on our luxury models. The marine grade aluminium (5052-H36 or 5052-H32) is .081" (2.05 mm) thick.



See photo montage on pages 18 & 19 showing various features and options. Some features shown may not be available on all models. You can find the complete list of standard and optional equipment on pages 22 & 23.



A third tube definitely improves the performance of a pontoon boat. This option permits the installation of an hydraulic steering system and the tube performance kit. Let's look at these performance details more closely

**Better performance**

Because a pontoon equipped with the third tube floats higher, it glides above the waves instead of crossing them, eliminating friction. This also allows to increase swiftness while not requiring more horsepower than a pontoon boat equipped with 2 tubes.

**Exceptional manoeuvrability**

A three-tube pontoon, equipped with the hydraulic steering system, is much easier to drive when turning and docking. With the middle toon WPT(Wide Performance Tube,) the bends are exceptional. Its "V" and flattened bottom shape, 36" (91 cm) wide x 28" (71 cm) deep, allows to race at high speed even in waves.

**Better stability**

The optional 34-gallon fuel tank built into the central 3rd tube increases the balance and cruising range of the pontoon. This eliminates the need for the tank under the sundeck, making room for even more storage.

**Smoother ride**

A third tube improves pontoon stability. Since the third tube increases contact with water at the center of the craft, the wave's pitch and surge effect is practically eliminated.

**Fuel economy**

Not only does the third tube improve performance, but better fuel economy is also achieved since less friction equals less work for the engine. In addition, the underside of the three-tube pontoon boat is entirely covered with aluminium, thus hiding the crossmembers. This eliminates another significant source of friction, further promoting fuel economy.

**More capacity**

A pontoon boat equipped with three toons greatly increases the load and power capacities.



Central teak floor path (full teak floor also available)



Mahogany hand-railings on doors



Rond teak table



Mahogany executive table, 54" x 22" (137 cm x 56 cm)

Teak step and half-cone set

**TEAK AND MAHOGANY**

SOUTHLAND, a leader manufacturer in Canada, earned recognition for its original products at the Toronto International Boat Show. SOUTHLAND now offers teak and mahogany on its pontoons, a first in the industry. SOUTHLAND furnishings made of teak or mahogany include tables, handrails, footboards and the deck.

**Signature SOUTHLAND**

The designers at SOUTHLAND are always looking for something new to make their product stand out from the rest and further elevate Signature SOUTHLAND. This time, they have chosen to offer teak and mahogany on their pontoons. We are talking about authentic wood fibre, not a cheap imitation of.

For this reason, they called on the co-operation and expertise of a company which, for the last 10 years, has specialized in manufacturing and installing furniture and decks made of teak and mahogany, including for the boating industry.

**TOP-OF-THE-LINE**

Through the years, the pontoon industry has continuously added equipment and refined its products. Pontoons now offer a level of comfort and luxury matched only by their convenience. The time had come to design these crafts with materials that increase their value significantly. Teak and mahogany are luxurious and attractive. They are also easy to recycle. In addition to being dignified and welcoming, they age beautifully and are easy to maintain. Finally, teak and mahogany are very comfortable. Walking on a teak deck, and feeling its warmth is practically therapeutic.

**LONGEVITY**

Longevity is a good indicator of the quality of a product. Tables and decks made of teak or mahogany offered by SOUTHLAND have almost unlimited longevity. The rubber fasteners holding each slat making up the deck are heat and water resistant. Developing this fastening material required years of research to make sure temperature fluctuations and water contact would alter neither its properties nor its appearance.

SOUTHLAND is proud to have contributed this advancement in water sports and opened possibilities for even more development.



Mahogany rectangular table



Mahogany sink cover





1. Dressing room  
2. Removable dressing room

Half cones/deck

Half cone with stairs & optional lighting

Front glass door

Oval baked laminate table

Multi-function module

LED light on bimini top's tube  
Minimum space required for installation is 3/4" (20 mm), 2" clearance. halogen is 17,5" long (44.5 cm)

Propane BBQ grill with rail (1 1/4") mounting bracket

Underseat storage tray

In-floor storage compartment  
1. Aluminium 2. P.V.C.

Chemical toilet with pump-out

Radio/CD/MP3 CLARION 200 watts

110 V and 120 V shore power inlet

Depth sounder

Search light

Available on 3-tube pontoon only

Telescopic light, optional on Champagne & X-Stream RA console

Chemical toilet with pump-out

GPS Lowrance

Removable drink holders

Tow bar for water sports

Side keel

2.4-cu.-ft. cooler with laminate door (standard on Champagne & X-Stream)

12 V refrigerator with stainless steel door (1.8-cu.-ft. capacity on Champagne and X-Stream)

1. Anodized fixed & folding ladder/w platform (standard on Champagne model) 2. Removable ladder

Anodized fixed & folding ladder/w platform

Courtesy light, chromium plated & blue lighting (Optional)

Flooring atmosphere lighting (Optional)



SOUTHLAND Full camper top

CUSTOMIZED TOPS



Captain's chair with bolster

Day cabin

Bimini top

Mooring cover

Shore light with 12 LED lights and remote control

Privacy kit (available tinted windows)

Full top without windows (Shed)

Deluxe ultra-comfort reclining chair with swivel & sliding armrests (standard on Champagne)

FISHING

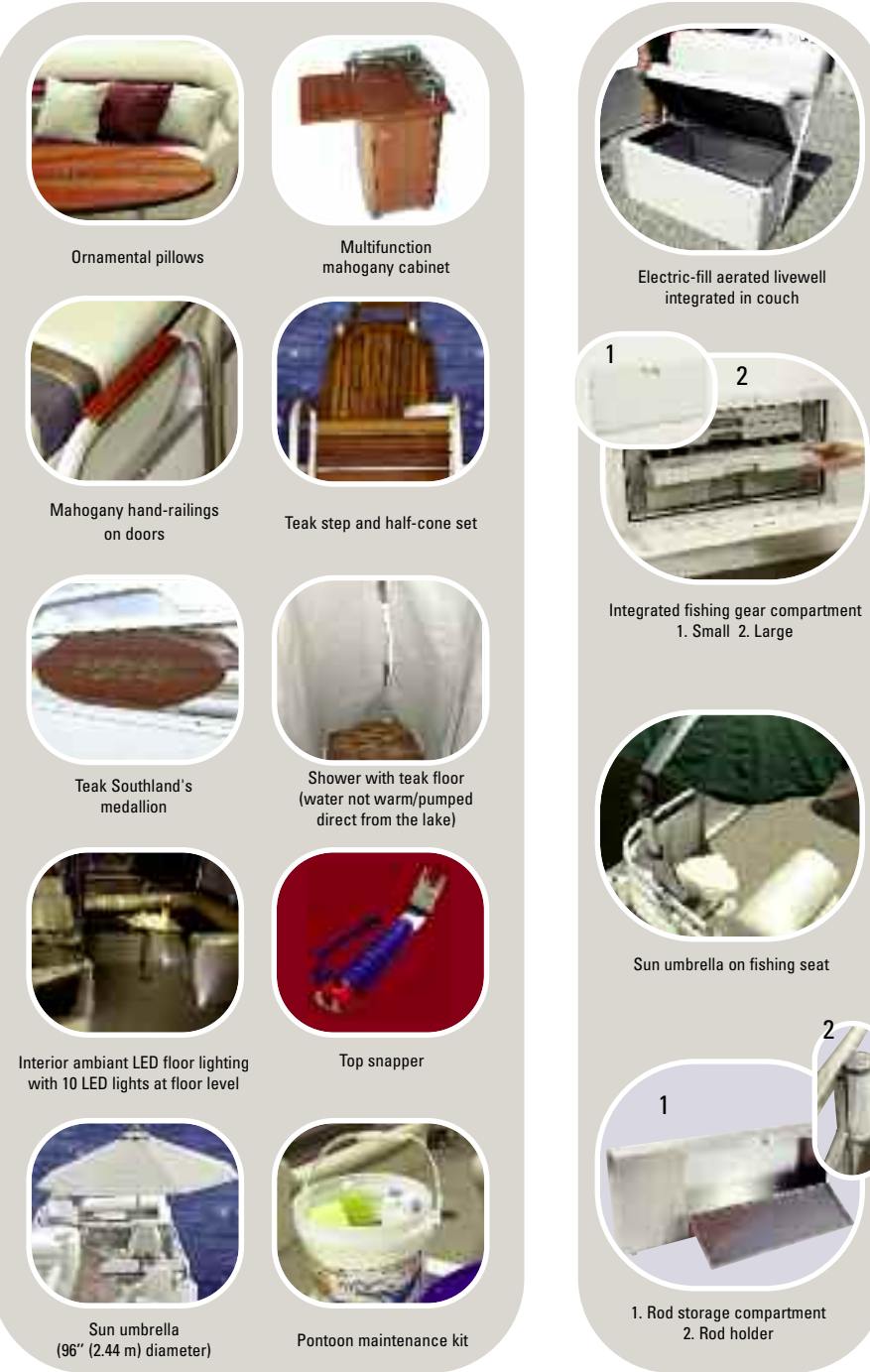

Ornamental pillows

Multifunction mahogany cabinet

Electric-fill aerated livewell integrated in couch

Mahogany hand-railings on doors

Teak step and half-cone set

Integrated fishing gear compartment  
1. Small 2. Large

Teak Southland's medallion

Shower with teak floor (water not warm/pumped direct from the lake)

Sun umbrella on fishing seat

Interior ambient LED floor lighting with 10 LED lights at floor level

Top snapper

Sun umbrella (96" (2.44 m) diameter)

Pontoon maintenance kit

1. Rod storage compartment  
2. Rod holder



Champagne SX 2686 D

**Edition Champagne SX**

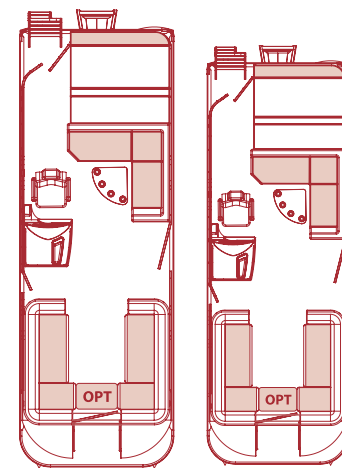

feet	2686-D	2486-D
meters	7,9-2,59-D	7,31-2,59-D

**Edition Champagne**

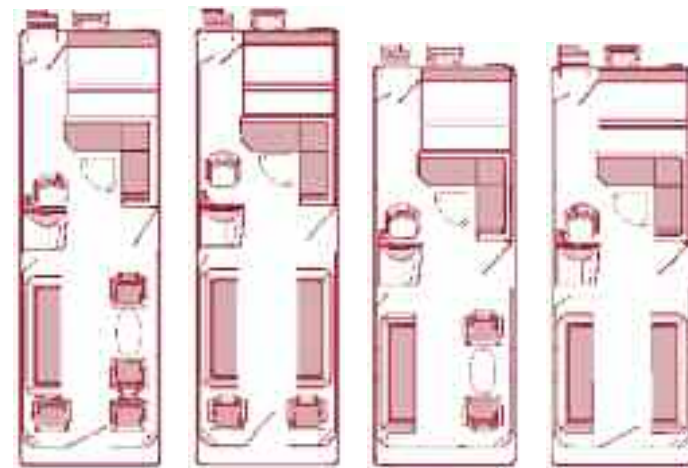

feet	2686-C	2686-D	2486-C	2486-D
meters	7,9-2,59-C	7,9-2,59-D	7,31-2,59-C	7,31-2,59-D

**X-Stream RA**

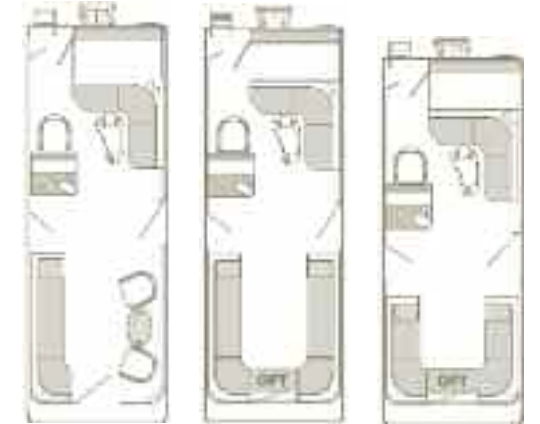

feet	2486-C	2486-D	2286-D
meters	7,31-2,59-C	7,31-2,59-D	6,7-2,59-D

**Luxuria-RA**



feet	2486-C	2486-D	2286-B	2286-D
meters	7,31-2,59-C	7,31-2,59-D	6,7-2,59-B	6,7-2,59-D

**Luxuria**



feet	2286-B*	2286-D*
meters	6,7-2,59-B	6,7-2,59-D

\*Also available in 2086 and 1886

**Diamond**

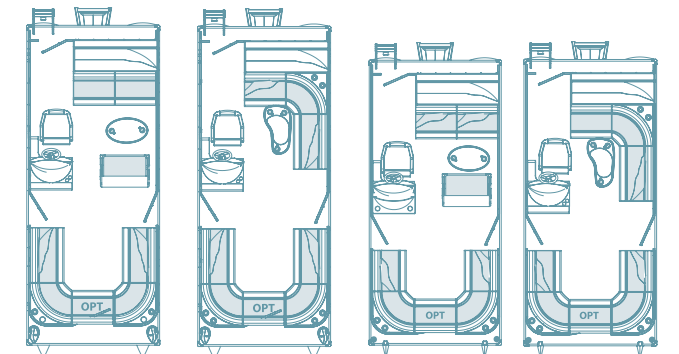

feet	2080-B	2080-D	1880-B	1880-D
meters	6,7-2,59-B	6,7-2,59-D	6,7-2,59-B	6,7-2,59-D

**Fishing DLX**

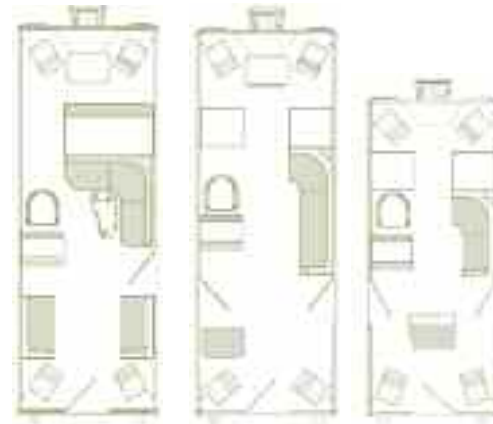

feet	2486-D DLX	2486-F DLX	2080-F DLX
meters	7,31-2,59-D DLX	7,31-2,59-F DLX	6,48-2,44-F DLX

**Horizon**

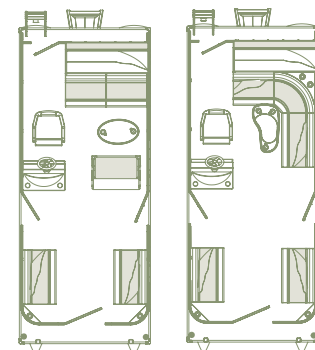

feet	2080-B*	2080-D*
meters	6,48-2,44-B	6,48-2,44-D

\* Also available in 1880 (5.49 m).

**Horizon Lite**

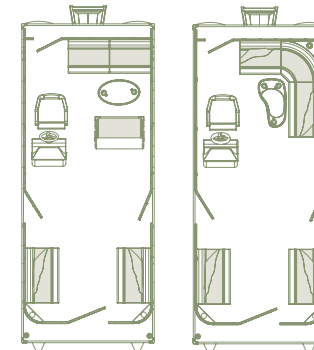

feet	2080-B*	2080-D*
meters	6,7-2,59-B	6,7-2,59-D

\* Also available in 1880 (4.88 m - 2.44 m).

**Fly SE**

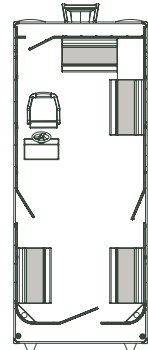

feet	2080*
meters	5,48-2,44

Fly also available in 1880, 1680 and 1660

\* Also available in 1880 and 1680 (4.88 m - 6.48 m).

**TOPS**

SOUTHLAND's full camper tops cover the pontoon's entire deck. That is, the canvas fastens to the very front of the deck, allowing for maximum enjoyment.

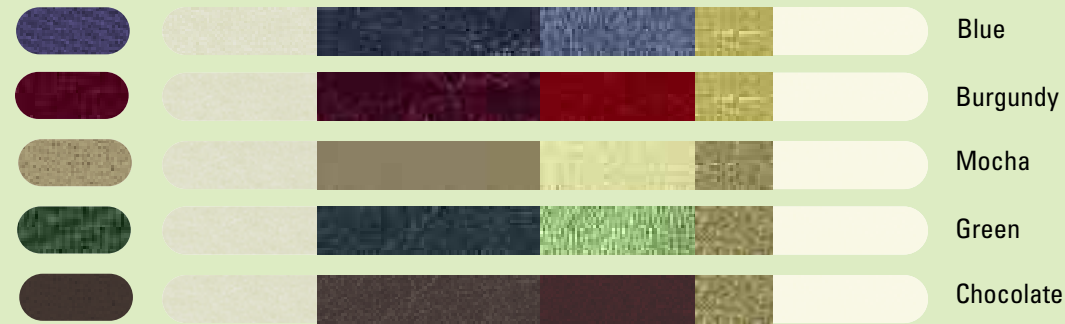

Chocolate color not available on Diamond, Horizon, Horizon Lite, Fly SE & Fly

See picture of chosen model for colour scheme. Actual colours may slightly differ from those shown here.





**SOUTHLAND**  
PRONAUBEC

**WARNING**  
The pictures and texts in this catalogue were prepared with the information available when printed. Please contact your SOUTHLAND dealer for the latest information on warranties, sizes, capacities, prices and services offered. Some pictures may be shown with some options. Changes may be brought to this catalogue without notification. The accessories shown or described in the catalogue may not be offered as standard or even optional equipment. Measurements are approximate and may vary.

**CERTIFICATION**  
SOUTHLAND is a registered member of the National Marine Manufacturers Association (NMMA). All models comply with regulations of the Canadian Coast Guard, the American Coast Guard and the European Community EC.

**EXCEPTIONAL PONTOONS – AN UNBEATABLE WARRANTY**

- **LIMITED LIFETIME WARRANTY** against product or workmanship defects on welds, including tube assembly, deck risers, gates and motor mount.\*
- **LIMITED LIFETIME WARRANTY** against insect or rot damage to plywood flooring. Limited lifetime replacement warranty on plywood and 5-year warranty on labour.
- **LIFETIME LIMITED WARRANTY** against deck warping.
- **1-YEAR WARRANTY** on Radio/CD units. We offer this warranty because we install only the best: CLARION.
- **5-YEAR WARRANTY IN NORTH AMERICA AND THREE YEAR WARRANTY OUT OF NORTH AMERICA** against excessive discoloration of "Top Gun" type canvas tops.
- **1-YEAR WARRANTY** covering parts and components manufactured by SOUTHLAND, as well as dashboards, gauges, switches, pumps, windshields, fuel tanks and hardware.

\* Except for pontoons equipped with Performance Package 3<sup>rd</sup> toon which are guaranteed for a period of 1 year.  
Note: This warranty does not cover engine and thrust components.  
See your nearest Dealer for more details on the best warranty available on the market.



Made in CANADA

795, avenue Guy-Poulin, Saint-Joseph de Beauce (Québec) CANADA G0S 2V0  
Tél: 418.397.8077 Téléc: 418.397.8015 www.southlandboat.com southland@southlandboat.com

Printed in Canada Copyright 2009 - Pronaubec inc. - All rights reserved  
Photos: Imagicon  
Pegaze Communication